

REPLACEMENT PARTS SUITABLE FOR ESAB®/L-TEC®

PT-15™, PT-15XL™

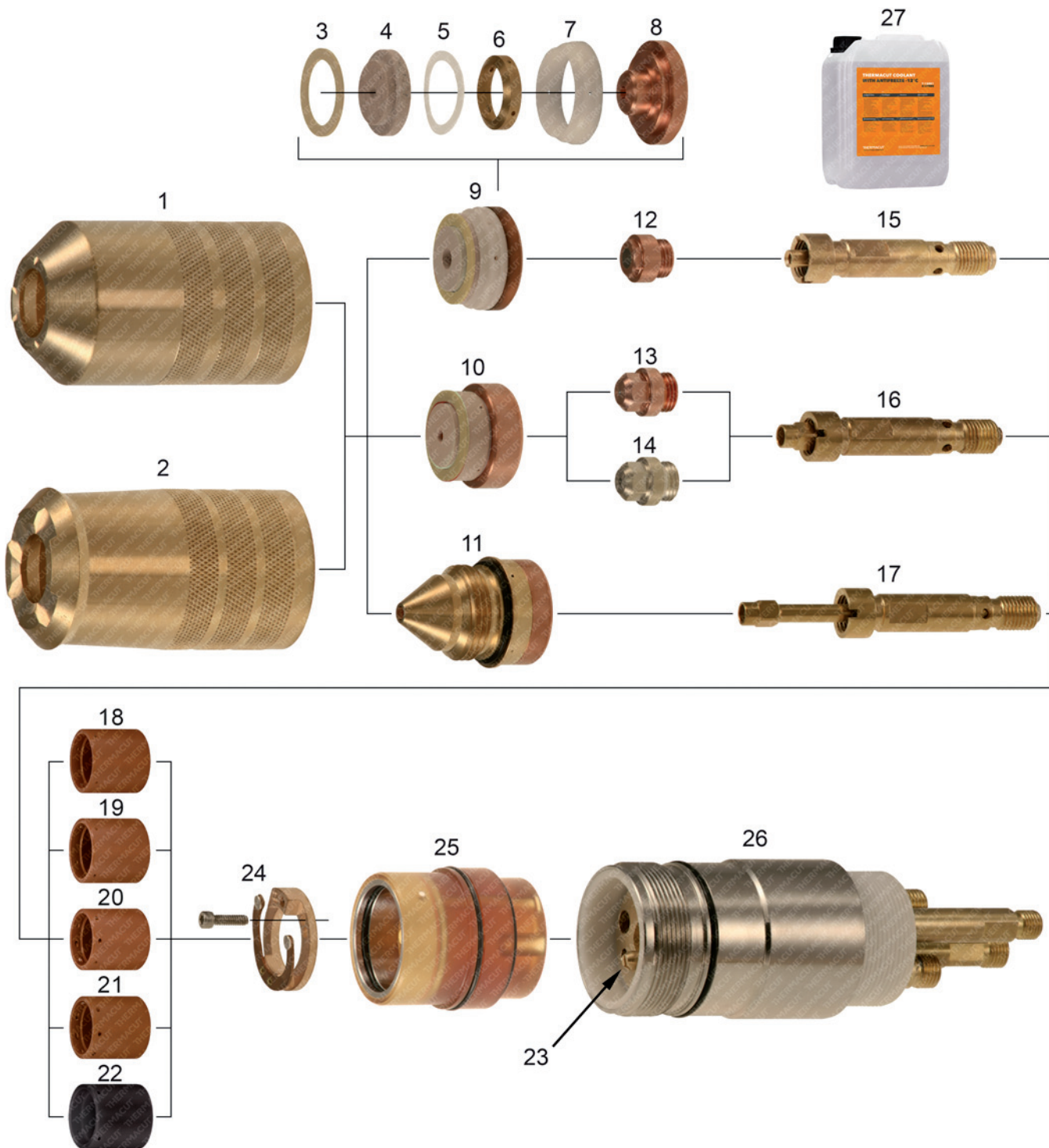

Last update of this page: 18/05/2017. See Revision history for details.

THERMACUT®
THE CUTTING COMPANY

WWW.THERMACUT.CZ
TEL.: +420 556 423 418
SALES@THERMACUT.CZ

WWW.THERMACUT.DE
TEL.: +49 (0) 27 39 40 33 0
INFO@THERMACUT.DE

WWW.THERMACUT.COM
TEL.: 1-603-542-6715
CUSTOMERSERVICE@THERMACUT.COM

THERMACUT®, FHT-EX® AND EX-TRAFIRE® ARE REGISTERED TRADEMARKS OF THERMACUT, K. S. AND MAY BE REGISTERED IN CZECH REPUBLIC AND/OR OTHER COUNTRIES. ALL OTHER TRADEMARKS ARE PROPERTIES OF THEIR RESPECTIVE OWNERS. THERMACUT IS NO WAY AFFILIATED WITH ESAB®/L-TEC®. MOST THERMACUT PARTS ARE MADE FOR OR BY AN IBG COMPANY. PARTS INDICATED WITH A OEM ARE ORIGINAL PARTS MANUFACTURED BY THE ABOVE NAMED MANUFACTURER AND ARE BEING RESOLD BY THERMACUT. THERMACUT RESERVES THE RIGHT TO SUBSTITUTE OEM PARTS IN PLACE OF THERMACUT PARTS. VALID FROM MAY 2017 • PREVIOUS VERSION IS NO LONGER VALID. • © COPYRIGHT 2017 BY THERMACUT® CZECH REPUBLIC. ALL RIGHTS RESERVED.

REPLACEMENT PARTS SUITABLE FOR ESAB®/L-TEC®

PT-15™, PT-15XL™

Item	Part No.	Ref. No.	Description	Std. Pkg.	Item	Part No.	Ref. No.	Description	Std. Pkg.
1.	T-0355	20758	Nozzle Retaining Cup, O ₂	1	11.	T-10209	21962	Nozzle Bevel 300A, O ₂	1
2.	T-1246	20759	Nozzle Retaining Cup, N ₂ /H ₃₅	1		T-10329	21963	Nozzle 260–300A, CCW	1
NS	T0356	996230	Retaining Cup	1	NS	T-11325	0558005866	Nozzle 400A O ₂ , Bevel	1
3.	T-0354	996628	Gasket	5	12.	T-0328	600236	Electrode 250–1000A, N ₂	5
4.	T-0350	2075693	Insulator, 0,140"	1	13.	T-0329	20763	Electrode 260A, O ₂	5
	T-0351	2075617	Insulator, 0,180"	5	14.	T-4900	20763-AG	Electrode 260A, O ₂ , SilverEX®	5
	T-0352	2075606	Insulator, 0,225"	5	15.	T-0326	2075343	Electrode Holder	1
	T-0353	2075607	Insulator, 0,260"	1	16.	T-0327	20398	Electrode Holder	1
	T-1604	2075588	Insulator, 0,500"	5	17.	T-1253	34084	Electrode Holder	1
NS	T-10683	20409-UR	Insulator	5	18.	T-0322	948142	Gas Swirl Baffle, 4 Hole, CW	1
5.	T-0349	996619	Spacer	1	19.	T-0323	948143	Gas Swirl Baffle, 4 Hole, CCW	1
6.	T-0346	2075584	Swirl Ring, 4 Hole, CW	1	20.	T-2019	35660	Gas Swirl Baffle, 8 Hole, CW	1
	PT-10567	2075616	Swirl Ring, 4 Hole, CCW	1	21.	T-11659	35661	Gas Swirl Baffle, 8 Hole, CCW	1
7.	T-0348	996618	Centering Sleeve	1	22.	T-0320	2075341	Gas Swirl Baffle, 4 Hole, CW, N ₂	2
8.	T-0345	19810	Nozzle Base 875–1000A	1		T-0321	2075360	Gas Swirl Baffle, 4 Hole, CCW, N ₂	1
	T-0342	2075608	Nozzle Base 400A	1		T-1869	1361201	Gas Swirl Baffle, 8 Hole, CW	1
	T-0343	2075609	Nozzle Base 600A	1	23.	T-1247	996242	Locating Pin	5
	T-0344	2075610	Nozzle Base 750A	1	24.	T-1248	21940 OEM	Contact Ring	1
9.	T-0332	2075611	Nozzle 400A, N ₂	1	25.	T-0319	20755	Insulator	1
	T-1966	2075612	Nozzle 600A, N ₂	1	26.	T-0318	20754	Torch Body, Machine	1
	T-1968	2075613	Nozzle 750A, N ₂	1	NS	T-10682**	20408-UR	H.F. Connector	1
	T-0333	2075614	Nozzle 400A, N ₂ , CCW	1	NS	T-10476**	17504-UR	Adaptor, Water-Out	1
	T-9645	2075615	Nozzle 600A, N ₂ , CCW	1	NS	T-10474**	17501-UR	Adaptor, Water Injection	1
	T-10321	20751-UR	Nozzle 260A, O ₂	1	NS	T-10475**	17503-UR	Adaptor, Water-In	1
	T-0338	2075587	Nozzle 875–1000A, H ₃₅	1	NS	KT-1447	20762	PT-15XL™ Torch with Leads 1,8m (6')	1
	T-1976	2075691	Nozzle 250A, N ₂	1	NS	KT-1159	000128	PT-15XL™ Cable Leads, 1,8m (6')	1
	T-3584	2075611-2	Nozzle 400A, N ₂	1	NS	KT-1118	K.PT-15XL.3M.K	PT-15XL™ Cable Leads, 3m (10')	1
10.	T-1716	35664	Nozzle 340A, O ₂	1	NS	KT-1160	000124	PT-15XL™ Cable Leads, 5,1m (17')	1
	T-0339	20751	Nozzle 260A, O ₂	1	NS	KT-1158	000129	PT-15XL™ Cable Leads, 6,1m (20')	1
	T-0340	20920	Nozzle 260A, O ₂ , CCW	1	NS	KT-1105	000328	PT-15XL™ Cable Leads, 7,6m (25')	1
	T-10322**	20920-UR	Nozzle 260A, O ₂ , CCW	1	27.	Coolant Liquid. Details on the page 152, section Accessories.			
	T-1715	35662	Nozzle 300A, O ₂	1					

** A UNIQUE DESIGN WHICH ENHANCES PERFORMANCE AND DIFFERS FROM OEM DESIGNS
CCW COUNTER CLOCK WISE GAS SWIRLING, USE OF CCW PARTS WILL MAKE CUT ANGLE ON THE OPPOSITE SIDE, THAN WITH STANDARD CLOCK WISE (CW) SWIRLING PARTS.

Last update of this page: 18/05/2017. See Revision history for details.

THERMACUT®
THE CUTTING COMPANY

WWW.THERMACUT.CZ
TEL.: +420 556 423 418
SALES@THERMACUT.CZ

WWW.THERMACUT.DE
TEL.: +49 (0) 27 39 40 33 0
INFO@THERMACUT.DE

WWW.THERMACUT.COM
TEL.: 1-603-542-6715
CUSTOMERSERVICE@THERMACUT.COM

THERMACUT®, FHT-EX® AND EX-TRAFIRE® ARE REGISTERED TRADEMARKS OF THERMACUT, K. S. AND MAY BE REGISTERED IN CZECH REPUBLIC AND/OR OTHER COUNTRIES. ALL OTHER TRADEMARKS ARE PROPERTIES OF THEIR RESPECTIVE OWNERS. THERMACUT IS NO WAY AFFILIATED WITH ESAB®/L-TEC®. MOST THERMACUT PARTS ARE MADE FOR OR BY AN IBG COMPANY. PARTS INDICATED WITH A OEM ARE ORIGINAL PARTS MANUFACTURED BY THE ABOVE NAMED MANUFACTURER AND ARE BEING RESOLD BY THERMACUT. THERMACUT RESERVES THE RIGHT TO SUBSTITUTE OEM PARTS IN PLACE OF THERMACUT PARTS.
VALID FROM MAY 2017 • PREVIOUS VERSION IS NO LONGER VALID. • © COPYRIGHT 2017 BY THERMACUT® CZECH REPUBLIC. ALL RIGHTS RESERVED.